

# Joseph L. Searles III Stadium



**KILLEEN INDEPENDENT SCHOOL DISTRICT**  
**JOSEPH L. SEARLES III STADIUM**  
**4400 Chaparral Road**  
**Killeen, TX 76542**

**KISD ATHLETICS ADMINISTRATION**

100 North 52<sup>nd</sup> Street  
Killeen, TX 76543  
Ph. 254-336-2672

Micah Wells – Executive Director for Athletics  
Kevin Lawler – Assistant Director for Athletics  
Lanny Williams – Assistant Director for Athletics  
Kristie Yonker – Athletics Technician  
Sheila Sortman – Athletics Secretary

**PARKING**

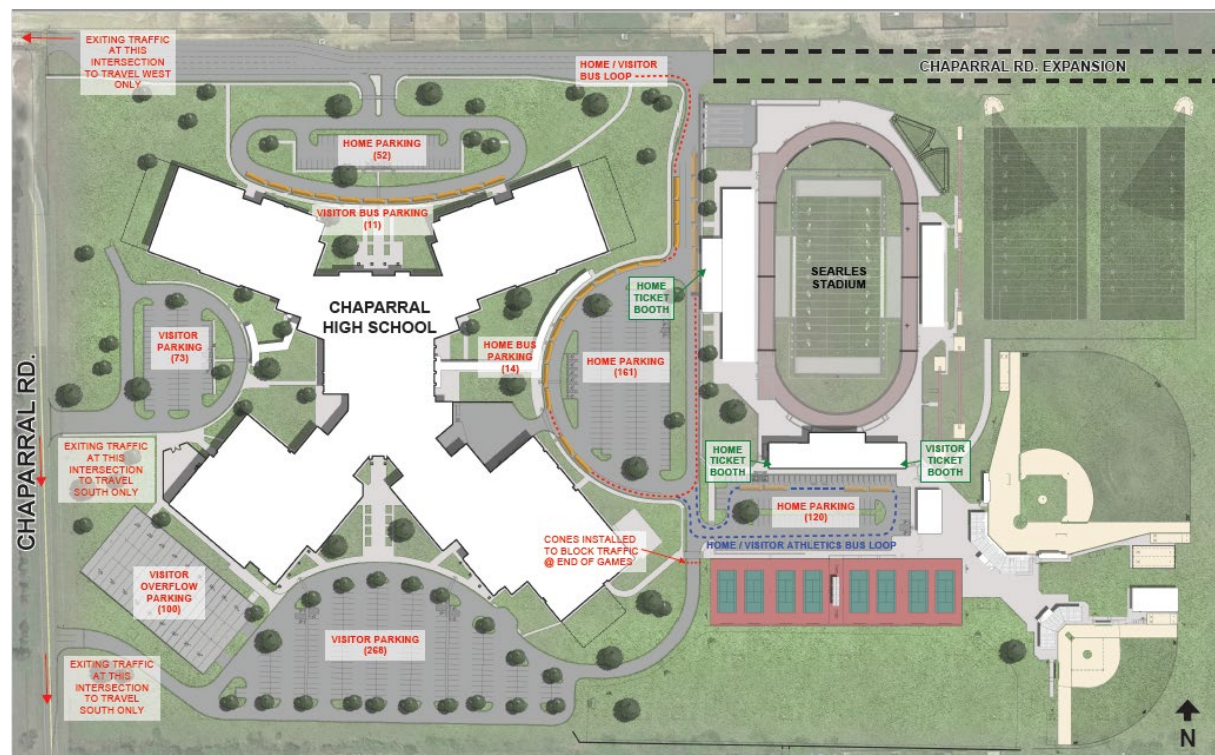

- Parking attendants will ensure the buses are parked correctly.
- Tailgating is prohibited.

### PLAYING FIELD REGULATIONS

- Dressing Rooms will be open 2 ½ hours before game time.
- Only water can be used on the field or track. No flavored drinks, such as Gatorade, may be used.
- Use of tobacco, sunflower seeds, and/or gum is prohibited.
- No metal cleats may be worn on the field or track.
- Absolutely no glass bottles, cans, or food allowed on the field or track. This includes cheerleaders and their support staff.
- All equipment, such as training tables, fans, and heaters, must have a protective base.
- No noise makers, cannons, or confetti.
- Band props must not mark or scar the field (chairs, ladders, etc.).
- All team personnel that are not in dress that would identify them as essential personnel must have a sideline pass. Cheerleaders that are in game uniform do not need a pass, but any support staff not in uniform must have a pass.
- Spectators are not allowed on the field or track before or after the games.

### STADIUM SEATING/REGULATIONS

- Wheelchair accessibility and viewing are available on both sides.
- Authorized personnel only will be allowed to cross over to the opposing side.
- No climbing over the rails onto the track.
- Air horns and/or bull horns are not permitted.
- Alcohol, tobacco, and firearms are prohibited, by law, on school property.
- No outside food or drink.
- No individual coolers, ice chests, and large food/beverage containers.
- No glass containers and bottles allowed in the stadium.
- No spectators will be allowed to sit in the end zones.

### PRESS BOX

- The press box will be open to coaches, filmers, and statisticians 2 hours prior to game time.
- Visitor Radio is located on the 3<sup>rd</sup> floor. Please email [kristie.yonker@killeenisd.org](mailto:kristie.yonker@killeenisd.org) if Visitor Radio will be in attendance.
- Scouts will be seated on a space available basis on the 3<sup>rd</sup> floor. Only teams scouting up to one week out will be allowed in the press box. Only 3 scouts allowed per campus. Please email [kristie.yonker@killeenisd.org](mailto:kristie.yonker@killeenisd.org) no later than 3 p.m. Tuesday of game week to reserve space. Check in at the elevator lobby to obtain a 3<sup>rd</sup> floor pass.

## TICKETS

- Tickets for varsity football games can be purchased online at the following link:

<https://www.etix.com/ticket/v/21308/killeen-football-visitor-side>



- Ticket gates will be open 1 ½ hours prior to game time.
- Students are not allowed in and out privileges; re-entry requires the purchase of a new ticket.
- Patrons without tickets must enter through the Pass Gate and show proper credentials.