

Welcome
Future Roo
Alumni



Graduation Rehearsal

GRADUATION AT BELL COUNT EXPO
SATURDAY, MAY 27, 2017
STUDENT CHECK-IN @ 1:30 PM
IN THE ASSEMBLY HALL



TRANSCRIPTS FOR THE CLASS OF 2017

Request Final Transcripts @
www.parchment.com

Create an account and
send your final transcript
to your college!

 **KILLEEN INDEPENDENT SCHOOL DISTRICT**
Immunization Record 5/1/2015

Student ID: [REDACTED] Campus: [REDACTED] Name: [REDACTED]
Date of Birth: 02/21/1995 Parent's Name: [REDACTED] Phone: [REDACTED]
Grade: 12 Source: PR - Personal Record

Shot Title	1st	2nd	3rd	4th	5th	TB Res	Exempt Code
DPT	05/08/1995	08/16/1995	04/23/1996	08/15/1996	03/17/1999		
Hepatitis A	06/09/2006	06/30/2009					
Hepatitis B	02/21/1995	05/08/1996	04/23/1996				
MM	05/08/1995	08/16/1995	04/23/1996	08/15/1996			
Measles-Mumps-Rubella	08/15/1996	03/17/1999					
Meningitis	09/30/2009						
Oval Poik	09/06/1995	08/16/1995	04/23/1996	03/17/1999			
Tdap	06/30/2009						
Varicella Disease History	02/21/1997						

EXEMPT CODES:
I - Illness
O - Objection
T - Temporary Medical
ER - Educational Record
E - Early But Valid
L - Local
P - Provisional Enroll
PR - Personal Record
H - History Of Diseases
M - Medical Lifetime
S - Serological/Titer

Source Codes:
Laquita Wright, BSN, RN
Nurses's Signature:  Date: May 1, 2015

WINCVS_R1_C0403030 1 of 1
If you have questions about how to run the report or how the report is pulling information, please contact Technology Services at 336-2734.

CHECKING INTO THE EXHIBITION HALL

- Check into the exhibition hall @ 1:30 PM, doors close at 2:45.
- Once you have checked in you may not leave.
- There are restrooms in the exhibition hall.
- Be in dress code as stated in contract, only KISD cords allowed.
- Once you check in with counselors and receive your card, immediately go to your row and get in place. Do not wander around and visit. If you are not in place when we leave, you will not walk.

- If you have a scheduled Grad Cast get your bracelet and card.

Assembly Hall Map

Outside Door
Student Check-in Open @ 1:30 PM, Closed Promptly @ 2:45 PM

BE IN DRESS CODE!!!



Card #'s 256 - 498



Card #'s 1 - 255

- 465-451
- 435-421
- 405-391
- 375-361
- 345-331
- 315-301
- 285-271
- 255-241
- 225-211
- 195-181
- 165-151
- 135-121
- 105-91
- 75-61
- 45-31
- 15 - 1

- 466-480
- 436-450
- 406-420
- 376-390
- 346-360
- 316-330
- 286-300
- 256-270
- 226-240
- 196-210
- 166-180
- 136-150
- 106-120
- 76-90
- 46-60
- 16-30

Entrance to the main floor of the ceremony.

RR

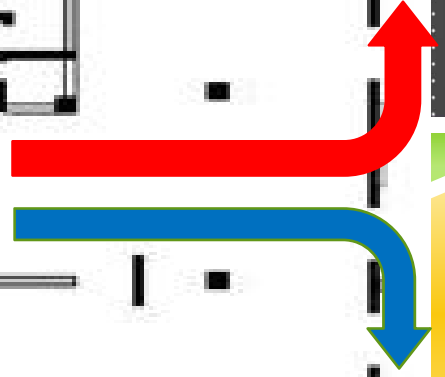

ARENA FLOOR MAP

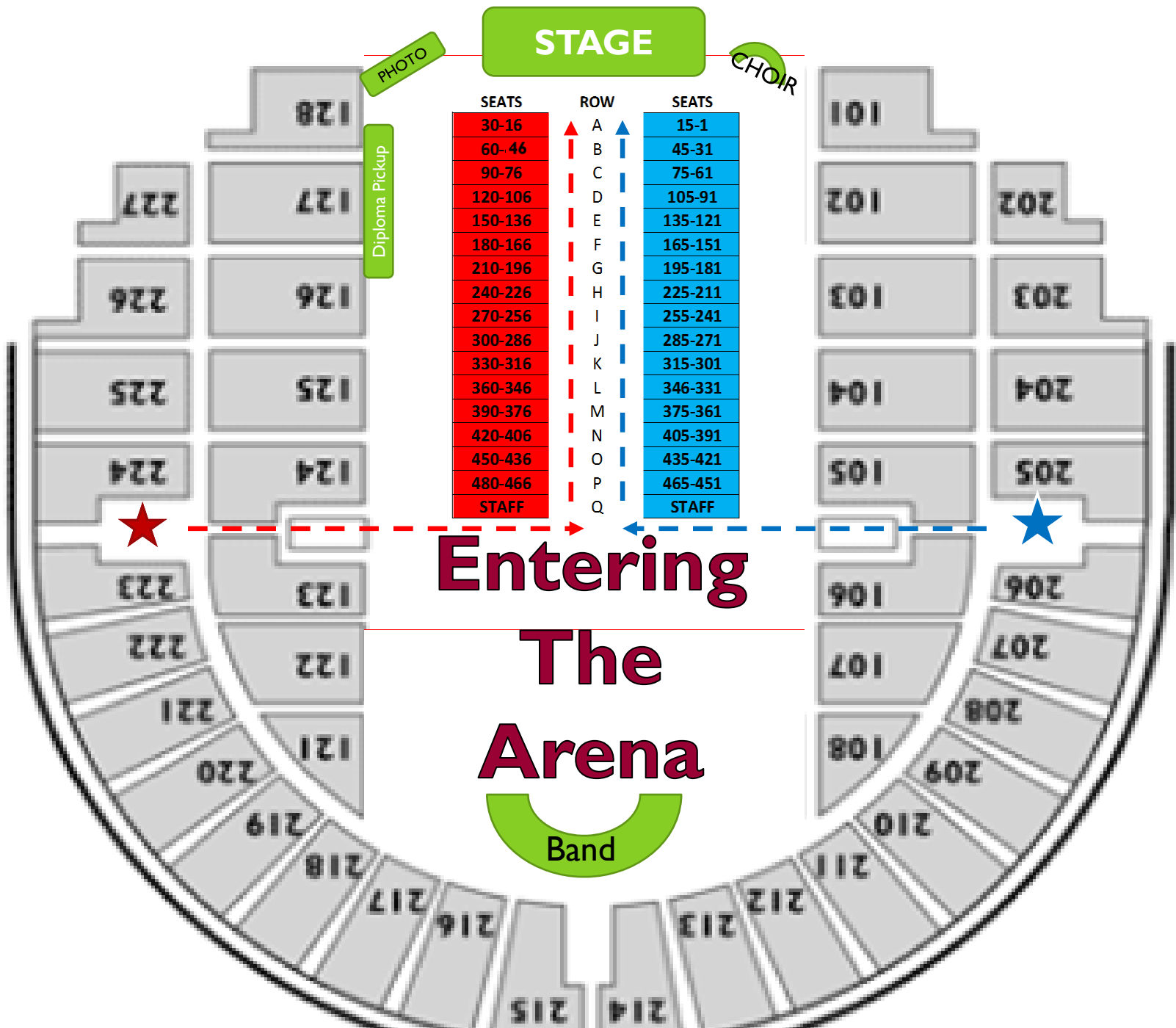

ARENA FLOOR MAP

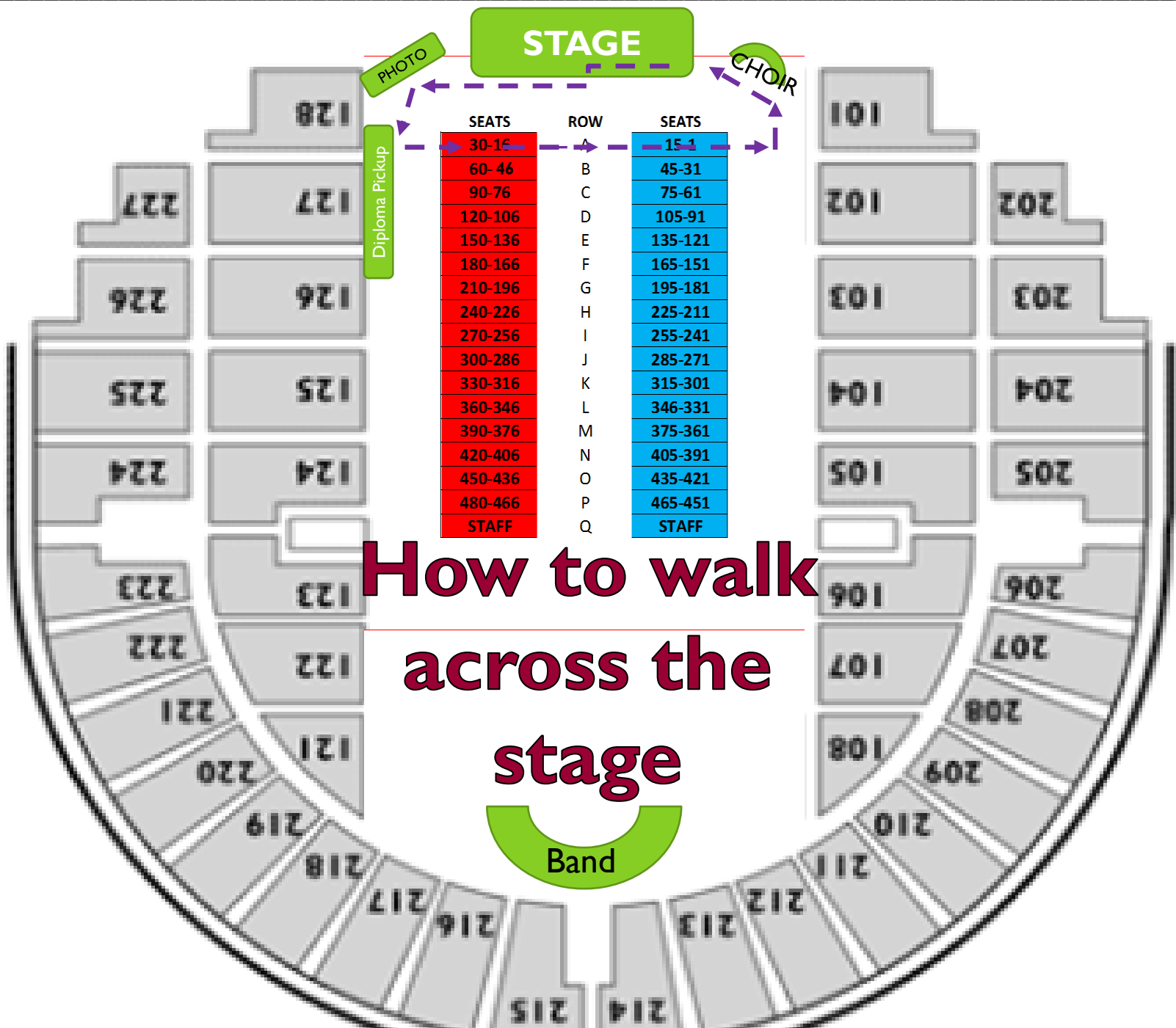

**How to walk
across the
stage**

Band

ARENA FLOOR MAP

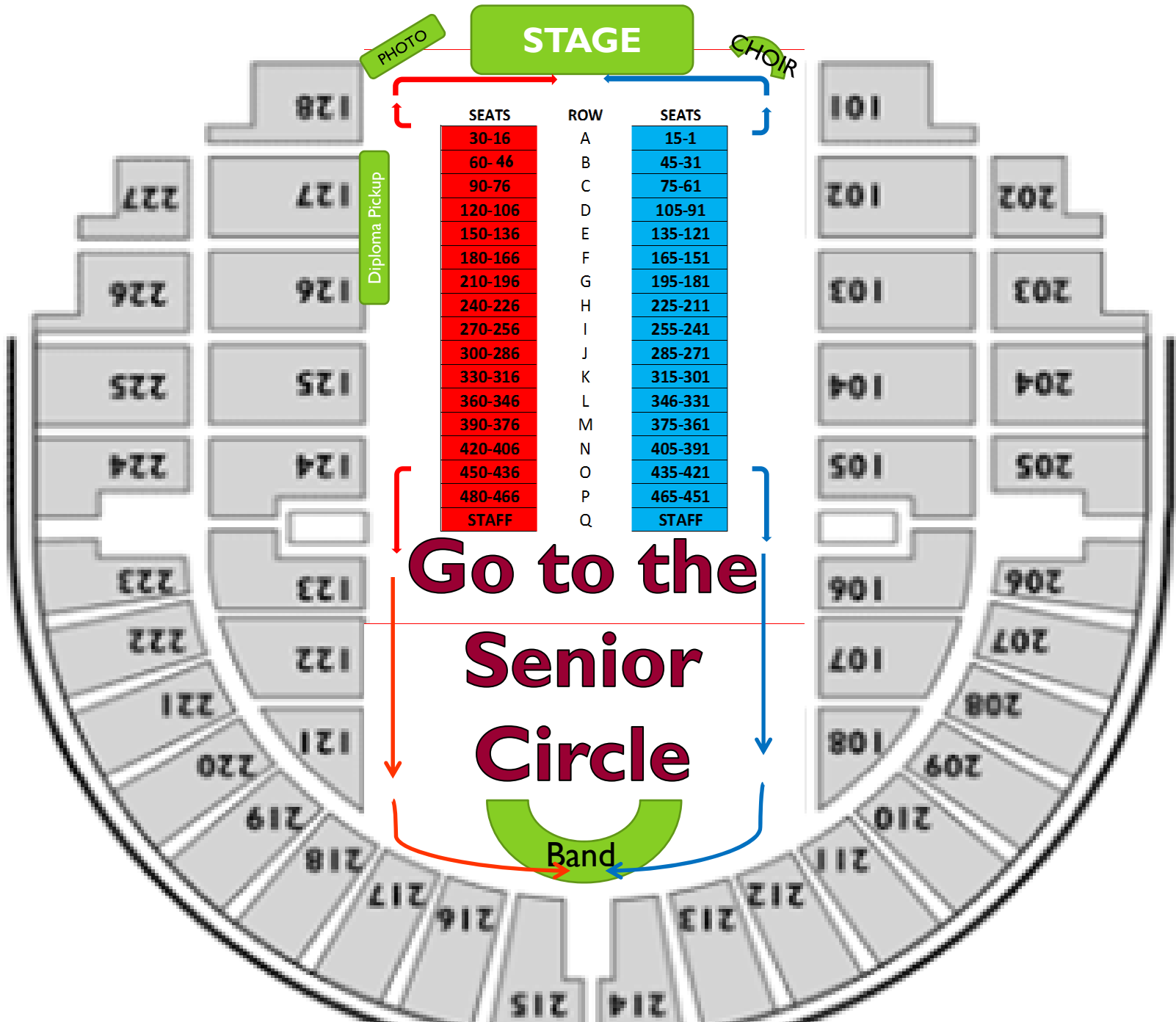

ARENA FLOOR MAP

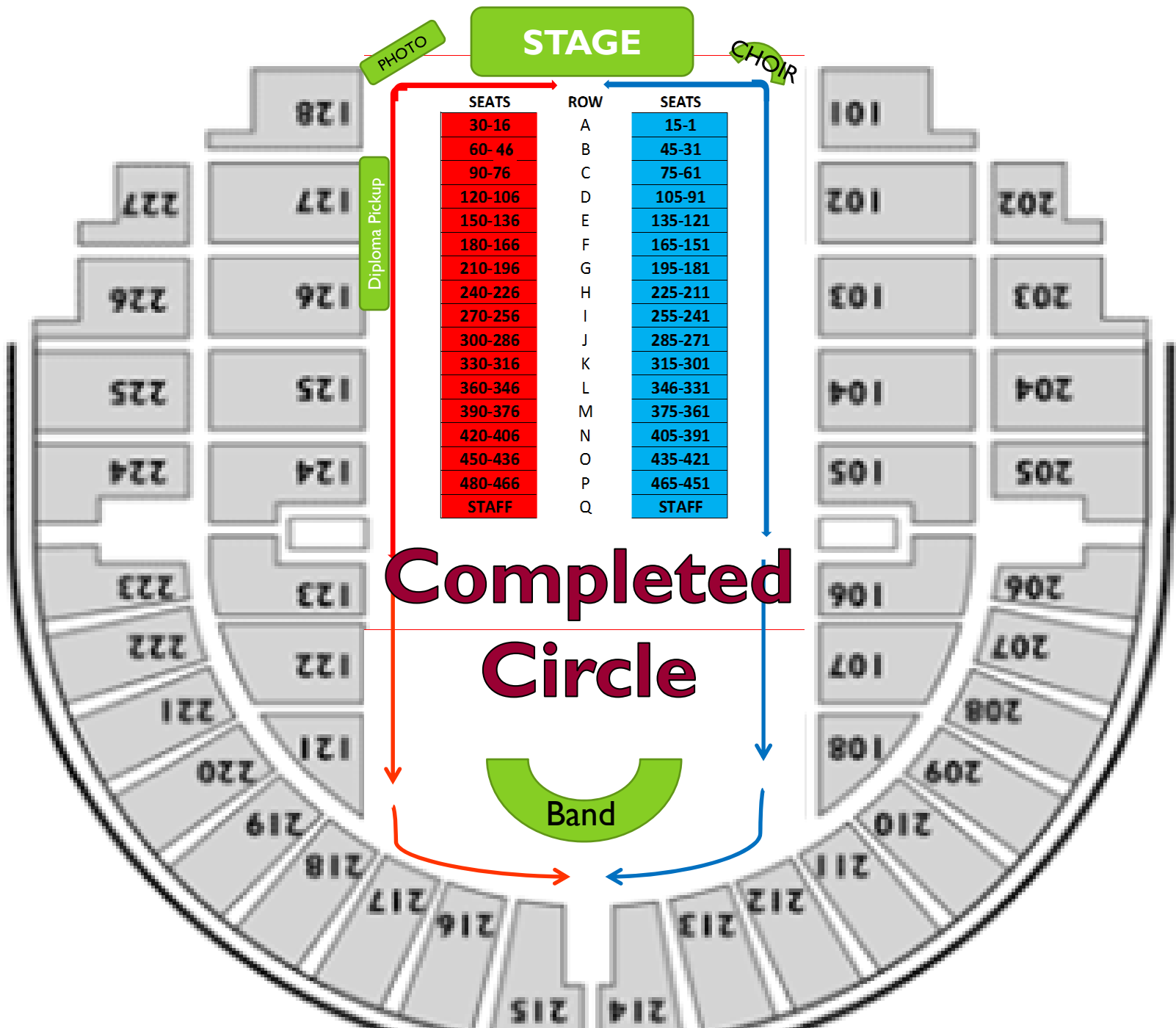

ARENA FLOOR MAP

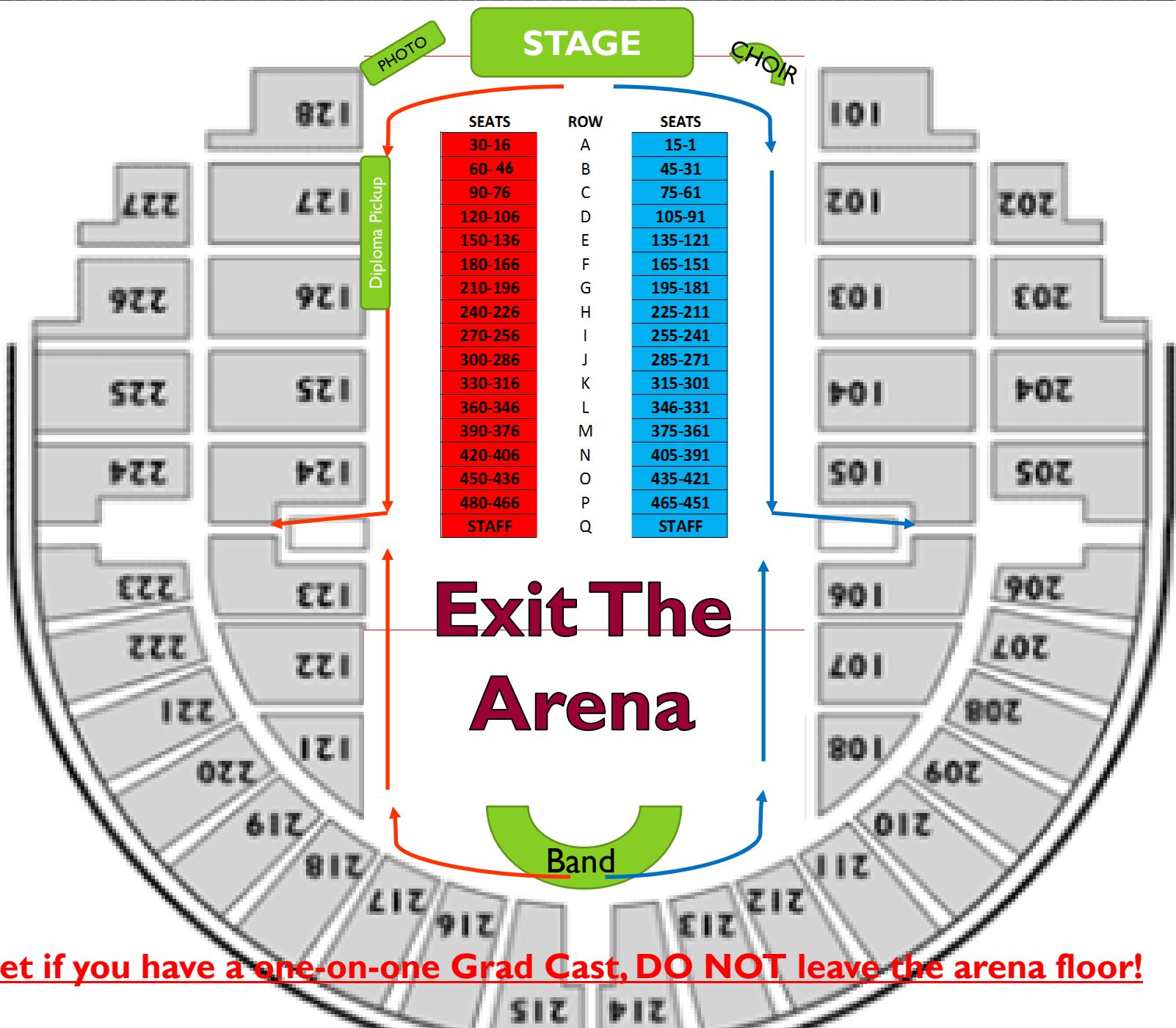

**Exit The
Arena**

Don't forget if you have a one-on-one Grad Cast, DO NOT leave the arena floor!